



## 21 Killarney Crescent Skennars Head NSW

3 2 2

Set in the highly sought-after seaside enclave of Skennars Head, just 400m from the beach, this solid brick-and-tile home offers the perfect blend of relaxed coastal living and family-friendly functionality. Lovingly maintained and tastefully updated over the years, 21 Killarney Crescent is ready to welcome its next chapter.

From the moment you enter, the home's flexible floorplan provides space and versatility for families of all shapes and sizes. The ground level features multiple bedrooms, ideal for kids or guests, and a sunny sitting room that opens directly onto a covered pergola and BBQ area-perfect for year-round entertaining. The established gardens offer privacy and the potential for future additions, with ample

[For full version visit the website](#)

**Type** : Semi Detached  
**Price** : \$ 1,300,000  
**Land Size** : 400 sqm  
**View** : <https://www.byronbaypropertyvalues.com.au/sale/nsw/northern-rivers/skennars-head/residential/semi-detached/8377829>



**Braden Walters**  
0411 637 373



**Harry McKinnon**  
66874447



GROUND FLOOR : 98m<sup>2</sup>



FIRST FLOOR : 93m<sup>2</sup>

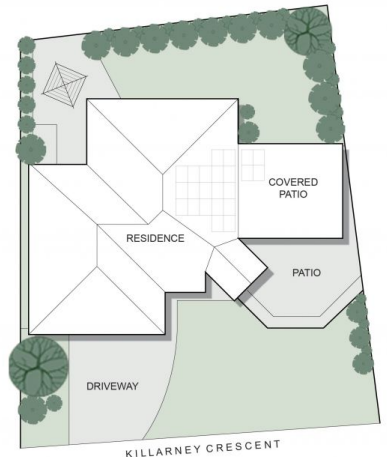

SITE PLAN

## 21 Killarney Crescent, Skennars Head

Floor Plan Disclaimer: Media Drive (MD) floor plans / site plans are intended as an approximate guide only. No representations or warranties of any nature are given or intended and any person using this information other than as a guide should always rely on their own enquiries Media Drive property marketing services / (041)2979654 / Photography, Floor plans, Video, Aerial photography / www.media-drive.com.au



APPROXIMATE AREAS	
INTERNAL FLOOR SPACE	157m <sup>2</sup>
EXTERNAL FLOOR SPACE	85m <sup>2</sup>
GARAGE	34m <sup>2</sup>